

Wand A

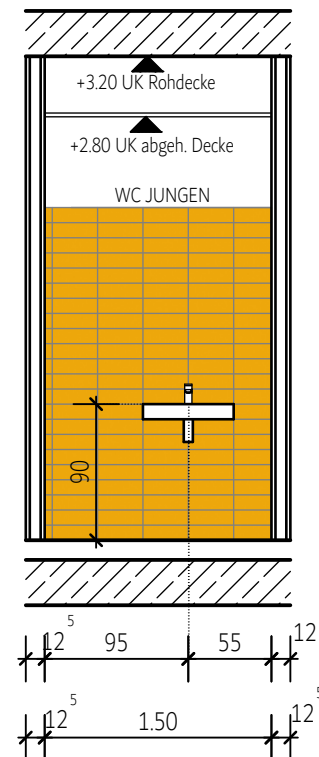

Wand B

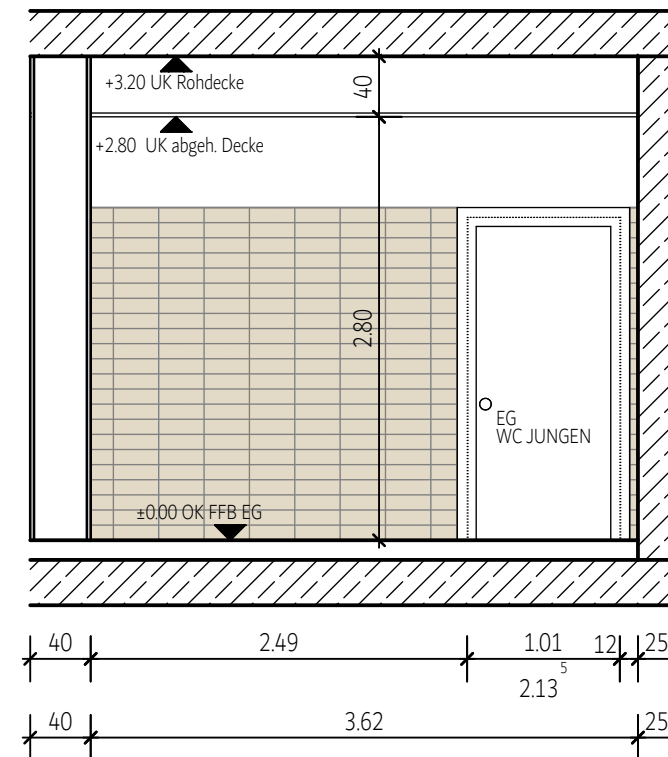

Wand C

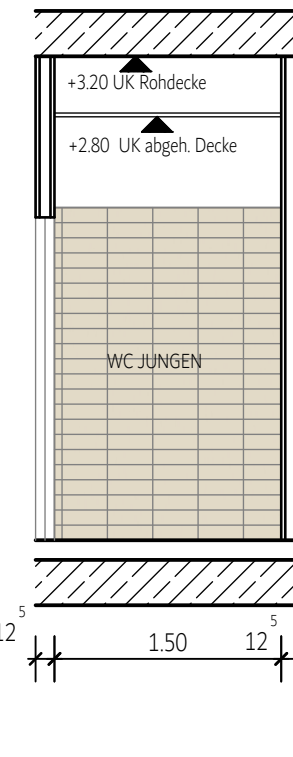

Wand D

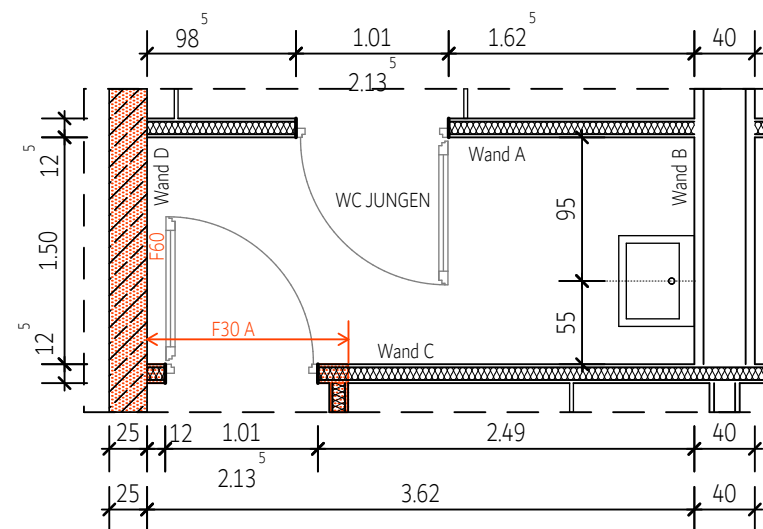

GRUNDRISS



Pro Architectura 3.0 - 10x30 - Mango Yellow



Pro Architectura 3.0 - 10x30 - Cream White

BAUVORHABEN	Umbau und Erweiterung eines ehemaligen Gaststättengebäudes zur FGTS Wehrden	
PLANNR. PLANINHALT	24_WPL_Wandabwicklung_WC Jungen Vorraum Wandabwicklung_WC Jungen Vorraum	
DATUM	14.04.2026	
MASZSTAB	M 1/50	